

Key Features

- Forged body for durability and high pressure applications
- Two ways, normally closed
- Working Pressure 0.1/0.3 ~ 6 Bar
- Rated protection: IP65
Watertight electrical enclosure for outdoor use
- Closing feature minimizes water-hammer on shut-off
- Working Voltage: AC24V, AC110V, AC230V, AC240V (50Hz/60Hz), DC12V, DC24V

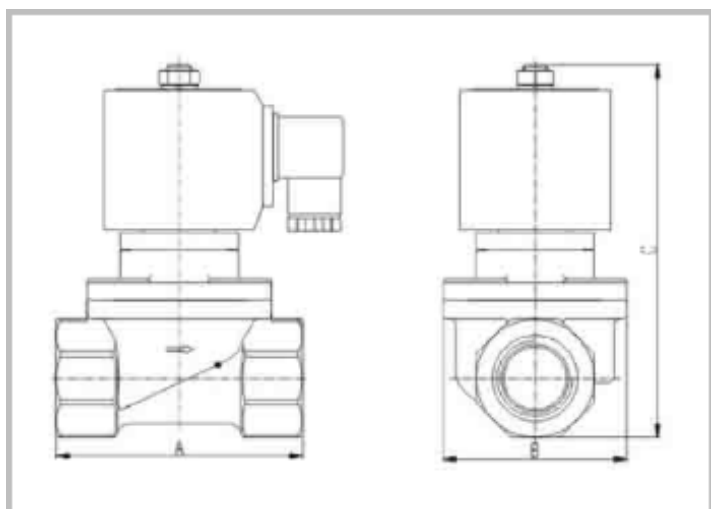

Model	Size	(mm)	Pressure	Length (mm)			Weight (Kg)
				L	W	H	
DHF21CL-15	1/2"	15	0.1 ~ 6 Bar	74	63	138	1.1
DHF21CL-20	3/4"	20	0.1 ~ 6 Bar	78	63	138	1.1
DHF21CL-25	1"	25	0.1 ~ 6 Bar	98	73	148	1.2
DHF21CL-32	1 1/4"	32	0.3 ~ 6 Bar	120	94	171	1.5
DHF21CL-40	1 1/2"	40	0.3 ~ 6 Bar	130	94	180	1.5
DHF21CL-50	2"	50	0.3 ~ 6 Bar	172	155	225	2.6



Specifications

- Valves body Material : uPVC
- Rated protection : IP65
- Sealing Material : VITON
- Temperature From : -5 to 60°C
- Durability : Corrosive liquid, Acid, Alkali, Air
- Working Pressure : 0.1/0.3 ~ 6 Bar

SANTA BARBARA CONTROL SYSTEMS

Santa Barbara, California USA

Leader in Chemical Automation since 1976

